

STRATA PLAN OF LOT 4,
EXCEPT: PHASE ONE STRATA PLAN LMS908
DL. 386, GP. 1,
N.W.D. PLAN LMP 5361

STRATA PLAN LMS908
PHASE TWO

CITY OF COQUITLAM



SCALE 1 : 750 DISTANCES ARE METRIC

B.C.G.S.92G.027



DEPOSITED AND REGISTERED IN THE LAND
TITLE OFFICE AT NEW WESTMINSTER B.C.
THIS 17 DAY OF JUNE 1994.

REGISTERED
DEPUTY REGISTRAR

BA 22 9995

CIVIC ADDRESS :

2985 - PRINCESS CRESCENT,
COQUITLAM, B. C.

" PRINCESS GATE "

NOTE:
FOR BUILDING DIMENSIONS
SEE SHEET 6

ELEV. DENOTES ELEVATOR
MACH. DENOTES MACHINE ROOM
ELEC. DENOTES ELECTRICAL ROOM

LEGEND :

- SL. DENOTES STRATA LOT
- m² DENOTES SQUARE METRES
- ⊙ DENOTES COMMON PROPERTY
- P-112 DENOTES PATIO BEING LIMITED COMMON PROPERTY FOR EXCLUSIVE USE OF SL. 112 (TYPICAL)
- B-137 DENOTES BALCONY BEING LIMITED COMMON PROPERTY FOR EXCLUSIVE USE OF SL. 137 (TYPICAL)
- DENOTES OLD IRON POST FOUND
- ⊕ DENOTES CONTROL MONUMENT

INTEGRATED SURVEY AREA No. 14 - COQUITLAM
THIS PLAN SHOWS GROUND - LEVEL MEASURED DISTANCES
PRIOR TO COMPUTATION OF UTM CO-ORDINATES MULTIPLY
BY COMBINED FACTOR 0.9995874.

GRID BEARINGS ARE DERIVED FROM
CONTROL MONUMENTS
73H0083 AND 73H0084

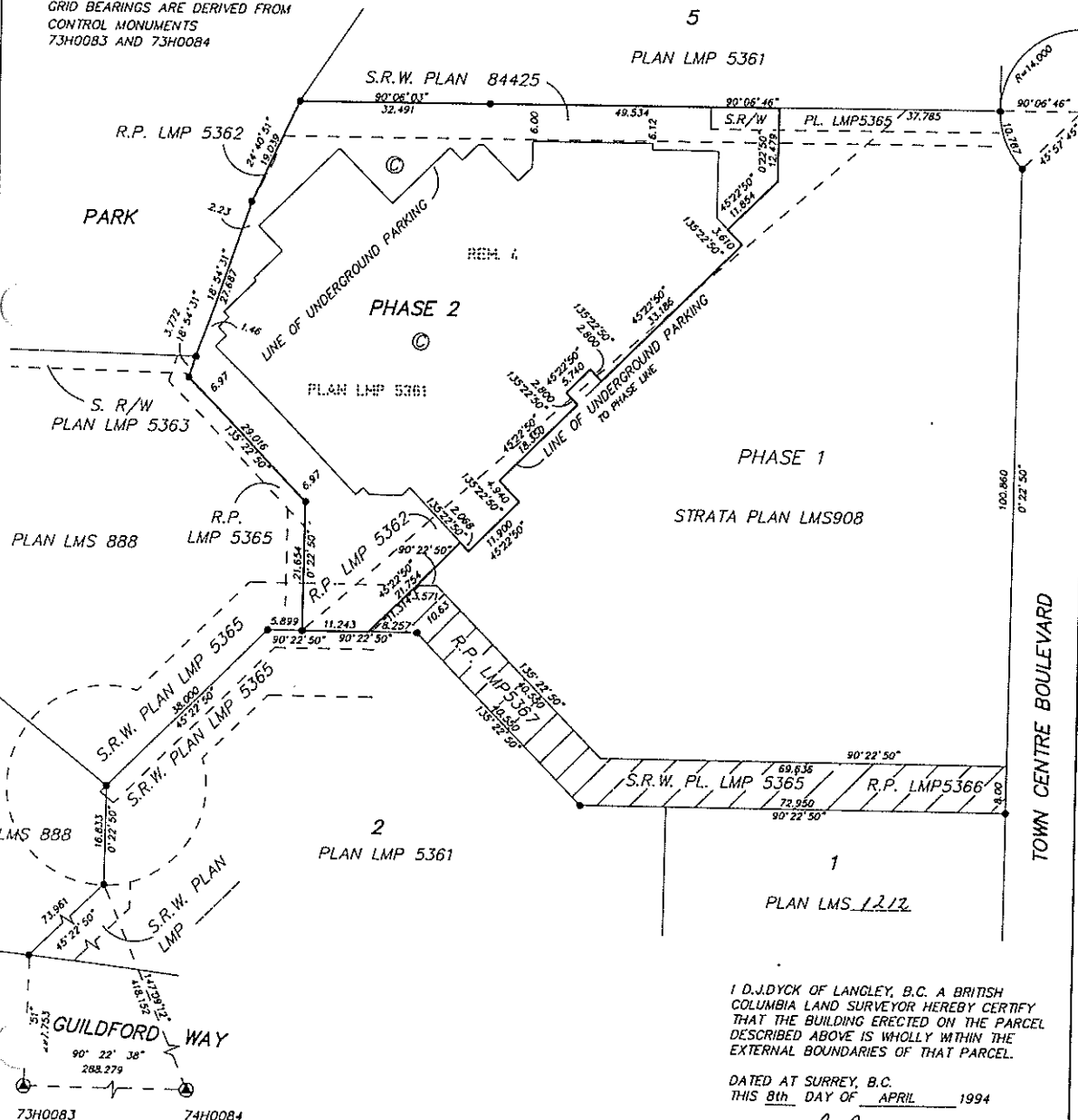

I D.J.DYCK OF LANGLEY, B.C. A BRITISH
COLUMBIA LAND SURVEYOR HEREBY CERTIFY
THAT THE BUILDING ERECTED ON THE PARCEL
DESCRIBED ABOVE IS WHOLLY WITHIN THE
EXTERNAL BOUNDARIES OF THAT PARCEL.

DATED AT SURREY, B.C.
THIS 8th DAY OF APRIL 1994

[Signature]

B.C.L.S.

THE ADDRESS FOR SERVICE OF DOCUMENTS
OF THE STRATA CORPORATION IS :
THE OWNERS, STRATA PLAN LMS 908
C/O 550 - 555 WEST 12th AVENUE,
VANCOUVER, B.C., V5Z 3X7

DYCK AND ASSOCIATES
208 - 6846 - KING GEORGE HIGHWAY
SURREY, B. C. V3W 4Z9
APRIL 8 1994

THIS PLAN LIES WITHIN THE GREATER
VANCOUVER REGIONAL DISTRICT

10

(

(

(

STRATA PLAN LMS908
PHASE TWO

OWNER:

POLYGON TOWN CENTRE
DEVELOPMENT LIMITED

[Signature]
AUTHORIZED SIGNATORY MICHAEL AUDAIN

[Signature]
AUTHORIZED SIGNATORY RALF SCHMIDTKE

[Signature]
WITNESS JANE WANG

PROJECT CO-ORDINATOR
OCCUPATION OF WITNESS

1800 SPYGLASS PLACE
ADDRESS OF WITNESS

APPROVED UNDER THE CONDOMINIUM ACT
AS TO PHASE 2 OF A TWO PHASE STRATA PLAN

DATED THIS 4th DAY OF June 1994

[Signature]
APPROVING OFFICER
CITY OF COQUITLAM

MORTGAGEE

NATIONAL BANK OF CANADA
by its authorized officer under no B6445045

[Signature]
AUTHORIZED SIGNATORY MICHAEL LEWIS
Senior Manager Real Estate

[Signature]
AUTHORIZED SIGNATORY JULIE HALLER
Assistant Account Manager Real Estate

WITNESS AS TO BOTH SIGNATURES
BRYANT J. LEWIS
BARRISTER SOLICITOR
OCCUPATION OF WITNESS

ADDRESS OF WITNESS 1500-1075 West Georgia
St. Vancouver, B.C. V6E 2G2

I, THE UNDERSIGNED DO SOLEMNLY DECLARE THAT
1.) I, THE UNDERSIGNED AM THE DULY AUTHORIZED
AGENT OF THE OWNER - DEVELOPER
2.) THE STRATA PLAN IS ENTIRELY FOR RESIDENTIAL USE
I MAKE THIS SOLEMN DECLARATION CONSCIENTIOUSLY
BELIEVING IT TO BE TRUE AND KNOWING THAT IT IS OF
THE SAME FORCE AND EFFECT AS IF MADE UNDER OATH

[Signature]
RALF SCHMIDTKE

DECLARED BEFORE ME AT VANCOUVER B.C.
THIS 12 DAY OF MAY 1994.

[Signature]
COMMISSIONER FOR TAKING AFFIDAVITS WITHIN
THE PROVINCE OF BRITISH COLUMBIA
J. G. R. THIRD

ACCEPTED AS TO FORMS 1, 2, AND 3
THIS 13 DAY OF June 1994.
[Signature]
SUPERINTENDENT OF REAL ESTATE

I D. J. DYCK OF LANGLEY, B.C. A BRITISH
COLUMBIA LAND SURVEYOR HEREBY CERTIFY
THAT THE BUILDING SHOWN IN THIS
STRATA PLAN HAS NOT AS OF
THE 8th DAY OF APRIL 1994
BEEN PREVIOUSLY OCCUPIED

DATED AT SURREY, B.C.
THIS 8th DAY OF APRIL 1994

[Signature]
B.C.L.S.

11

(

(

(

STRATA PLAN LMS908
 PHASE TWO

CONDOMINIUM ACT

LOT No.	SHEET No.	FORM 1	FORM 2	FORM 3
		SCHEDULE OF UNIT ENTITLEMENT	SCHEDULE OF INTEREST UPON DESTRUCTION	SCHEDULE OF VOTING RIGHTS
		UNIT ENTITLEMENT	INTEREST UPON DESTRUCTION	No OF VOTES
112	7	974	146	
113	7	1013	152	
114	7	1065	160	
115	7	1002	150	
116	7	777	124	
117	7	742	119	
118	7	742	119	
119	7	1161	174	
120	7	1026	154	
121	7	1011	152	
122	7	1011	152	
123	7	1002	150	
124	7	1170	176	
125	7	1170	176	
126	7	741	119	
127	7	1103	165	
128	7	1157	174	
129	8	974	156	
130	8	1013	162	
131	8	1065	170	
132	8	1002	160	
133	8	777	130	
134	8	742	124	
135	8	742	124	
136	8	1058	169	
137	8	1161	186	
138	8	1026	164	
139	8	1011	162	
140	8	1011	162	
141	8	1002	160	
142	8	1170	187	
143	8	1170	187	
144	8	741	124	
145	8	1103	176	
146	8	1135	182	
147	8	978	156	
148	9	974	156	
149	9	1013	162	

STRATA PLAN LMS908
PHASE TWO

CONDOMINIUM ACT

LOT No.	SHEET No.	FORM 1	FORM 2	FORM 3
		SCHEDULE OF UNIT ENTITLEMENT	SCHEDULE OF INTEREST UPON DESTRUCTION	SCHEDULE OF VOTING RIGHTS
		UNIT ENTITLEMENT	INTEREST UPON DESTRUCTION	No OF VOTES
150	9	1065	170	
151	9	1002	160	
152	9	777	130	
153	9	742	124	
154	9	742	124	
155	9	1058	169	
156	9	1161	189	
157	9	1026	165	
158	9	1011	162	
159	9	1011	162	
160	9	1002	160	
161	9	1002	160	
162	9	1047	170	
163	9	1002	160	
164	9	741	124	
165	9	1103	176	
166	9	1135	182	
167	9	978	156	
168	10	974	170	
169	10	1013	177	
170	10	1065	186	
171	10	1002	175	
172	10	777	141	
173	10	742	135	
174	10	742	135	
175	10	1058	185	
176	10	1161	203	
177	10	1026	180	
178	10	1011	177	
179	10	1011	177	
180	10	1002	175	
181	10	1002	175	
182	10	888	162	
183	10	1002	175	
184	10	741	135	
185	10	1103	193	
186	10	1135	199	
187	10	978	171	
AGGREGATE		74773	12190	



BASEMENT FLOOR PLAN

STRATA PLAN LMS908

PHASE TWO

0 5 10 15 20
SCALE 1 : 250 DISTANCES ARE METRIC

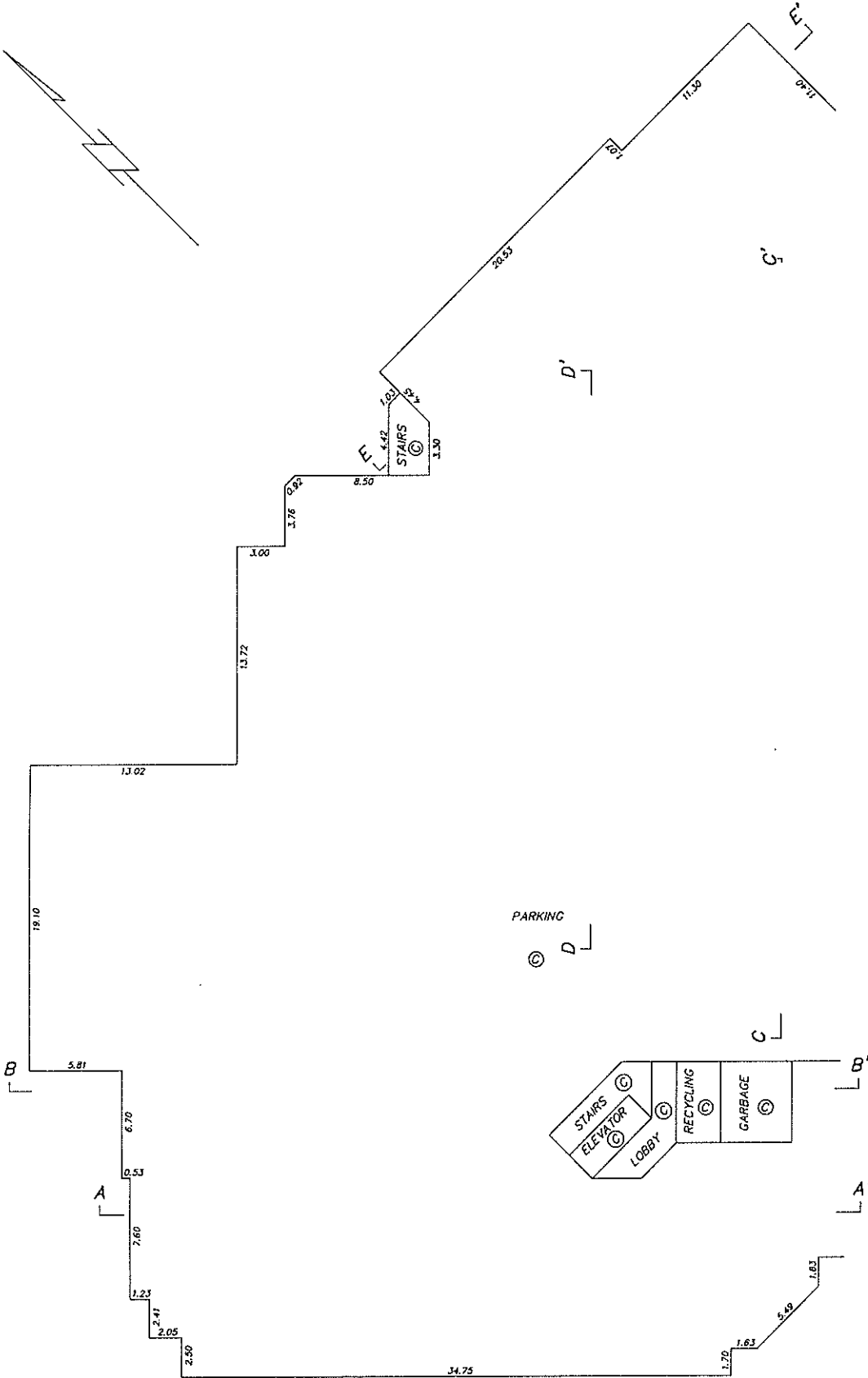

del
APRIL 8, 1994
FILE: 92-1720

10

(

(

(

BASEMENT FLOOR PLAN

STRATA PLAN LMS908

PHASE TWO

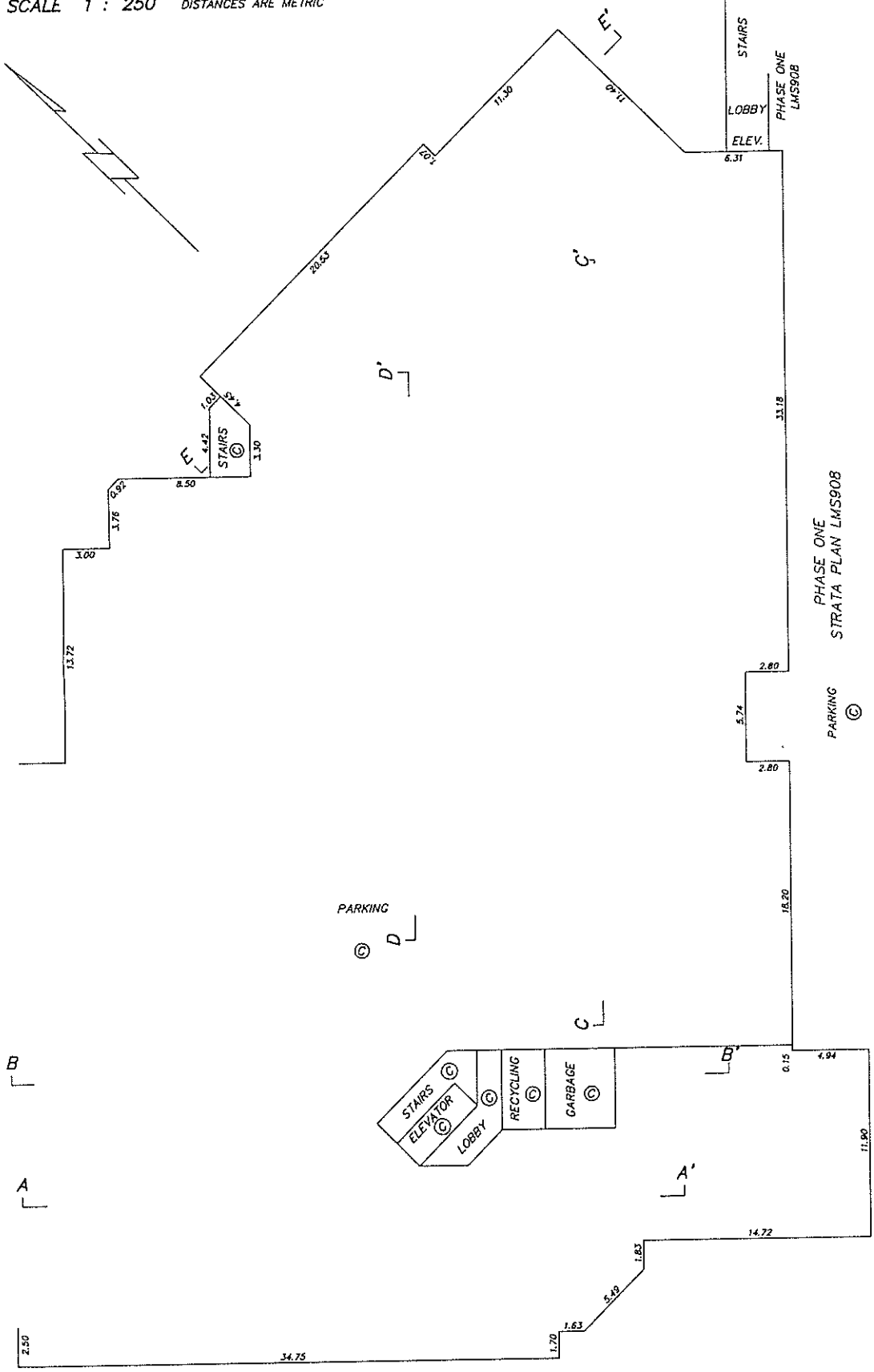
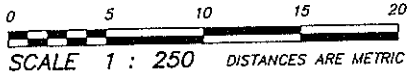

sl
APRIL 8, 1994
FILE: 92-1720

10

(

(

(

FIRST FLOOR PLAN

STRATA PLAN LMS908

PHASE TWO

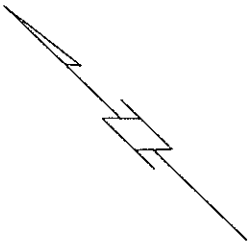
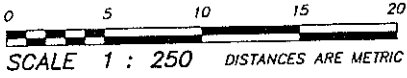

BASEMENT OUTLINE

BASEMENT OUTLINE

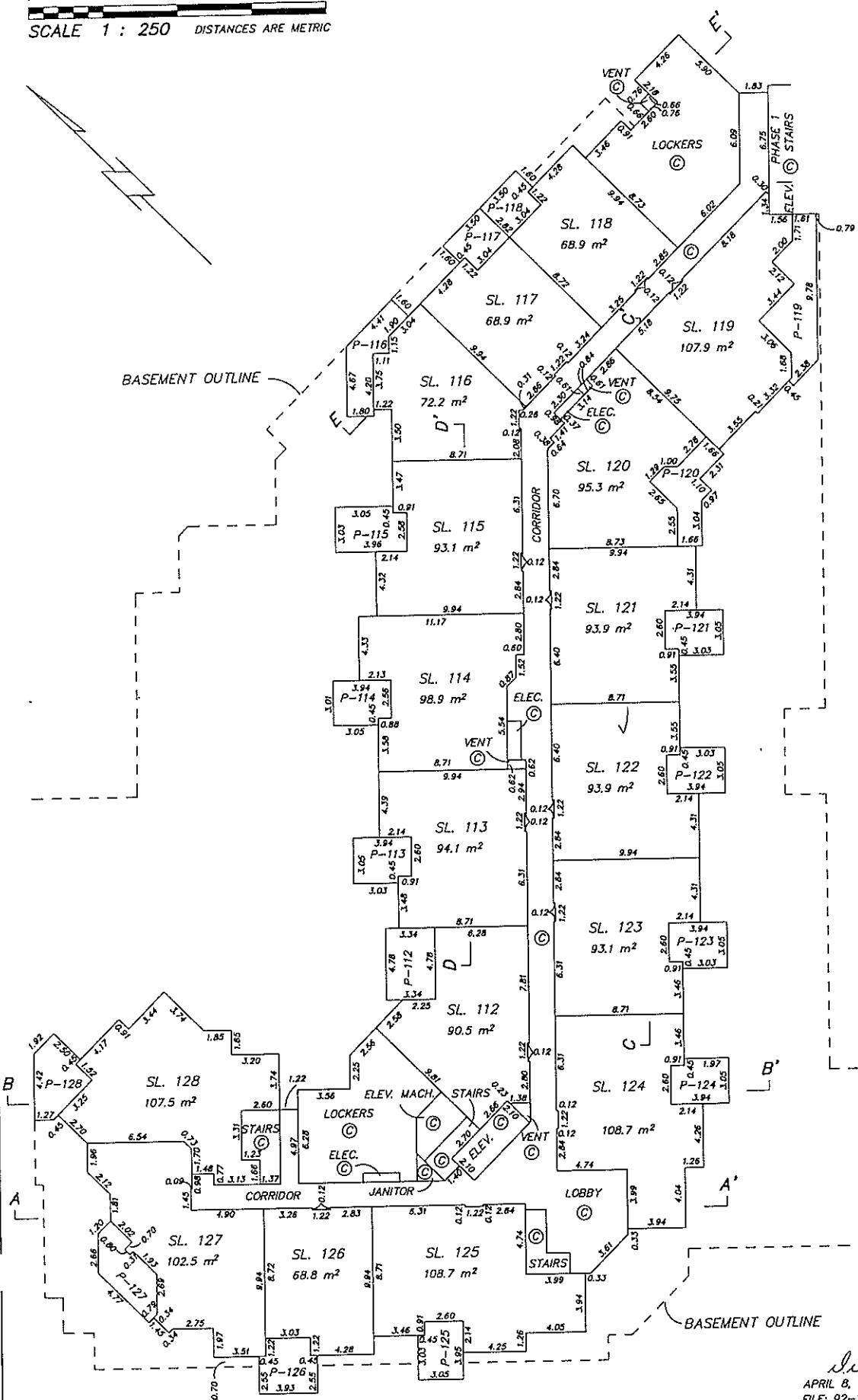

Handwritten signature
 APRIL 8, 1994
 FILE: 92-1720

SECOND FLOOR PLAN

STRATA PLAN LMS908

PHASE TWO

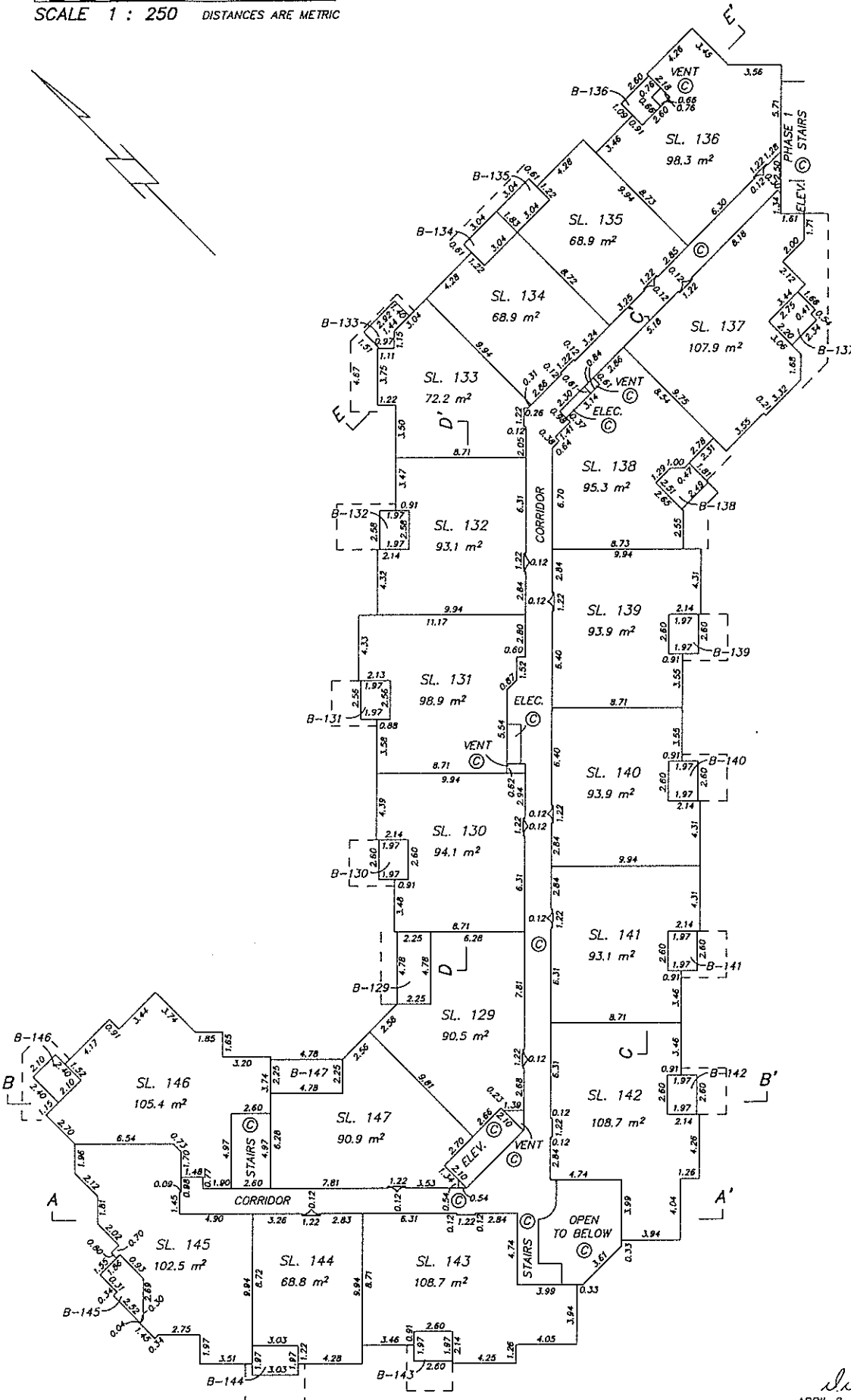
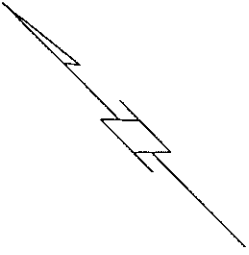
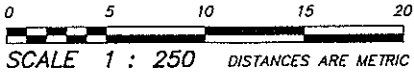

J.S.
APRIL 8, 1994
FILE: 92-1720

10

(

(

(

THIRD FLOOR PLAN

STRATA PLAN LMS908

PHASE TWO

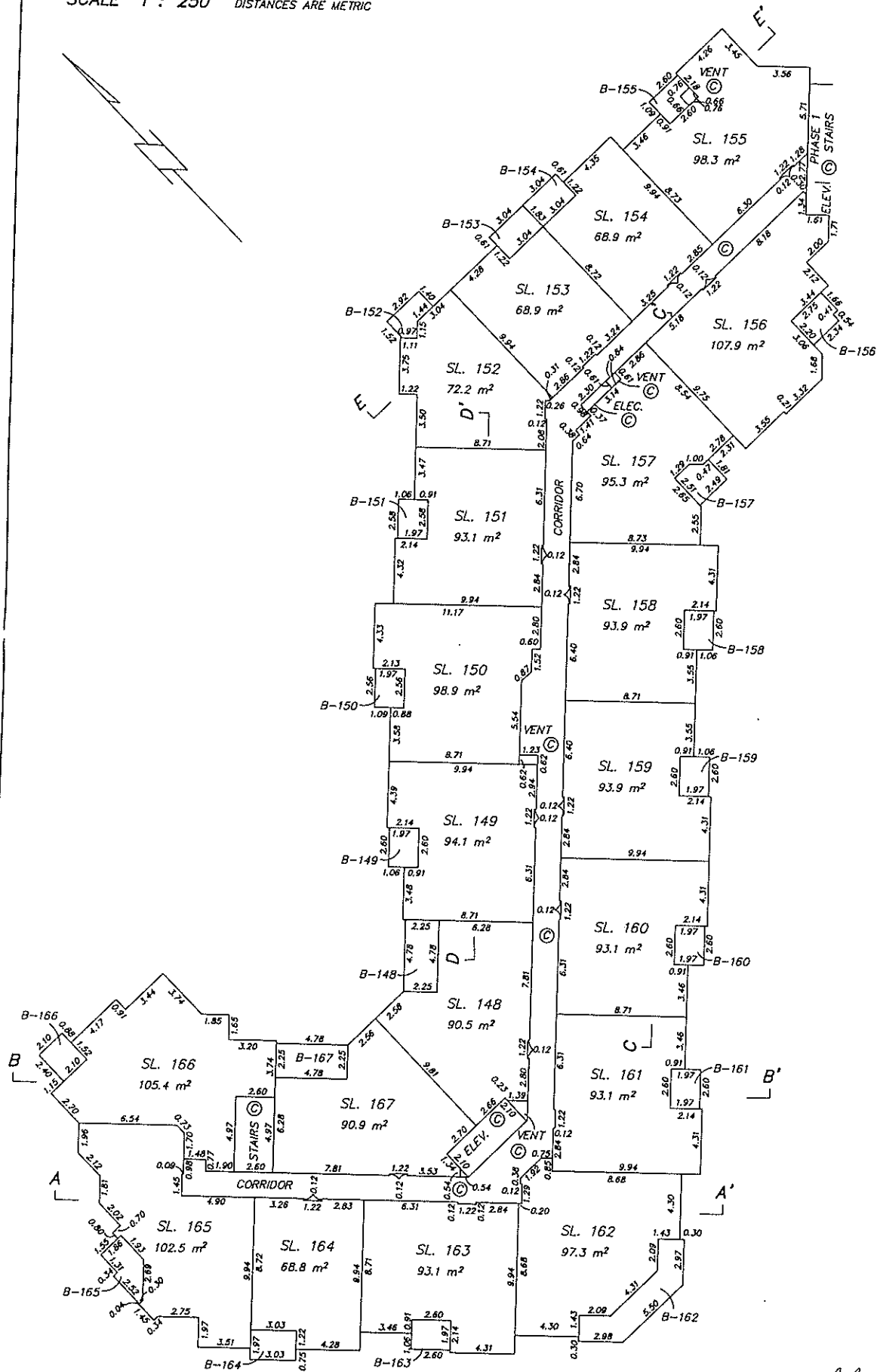
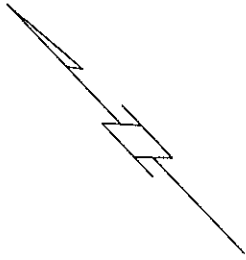
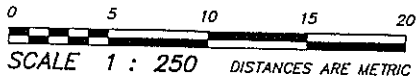

FOURTH FLOOR PLAN

STRATA PLAN LMS908

PHASE TWO

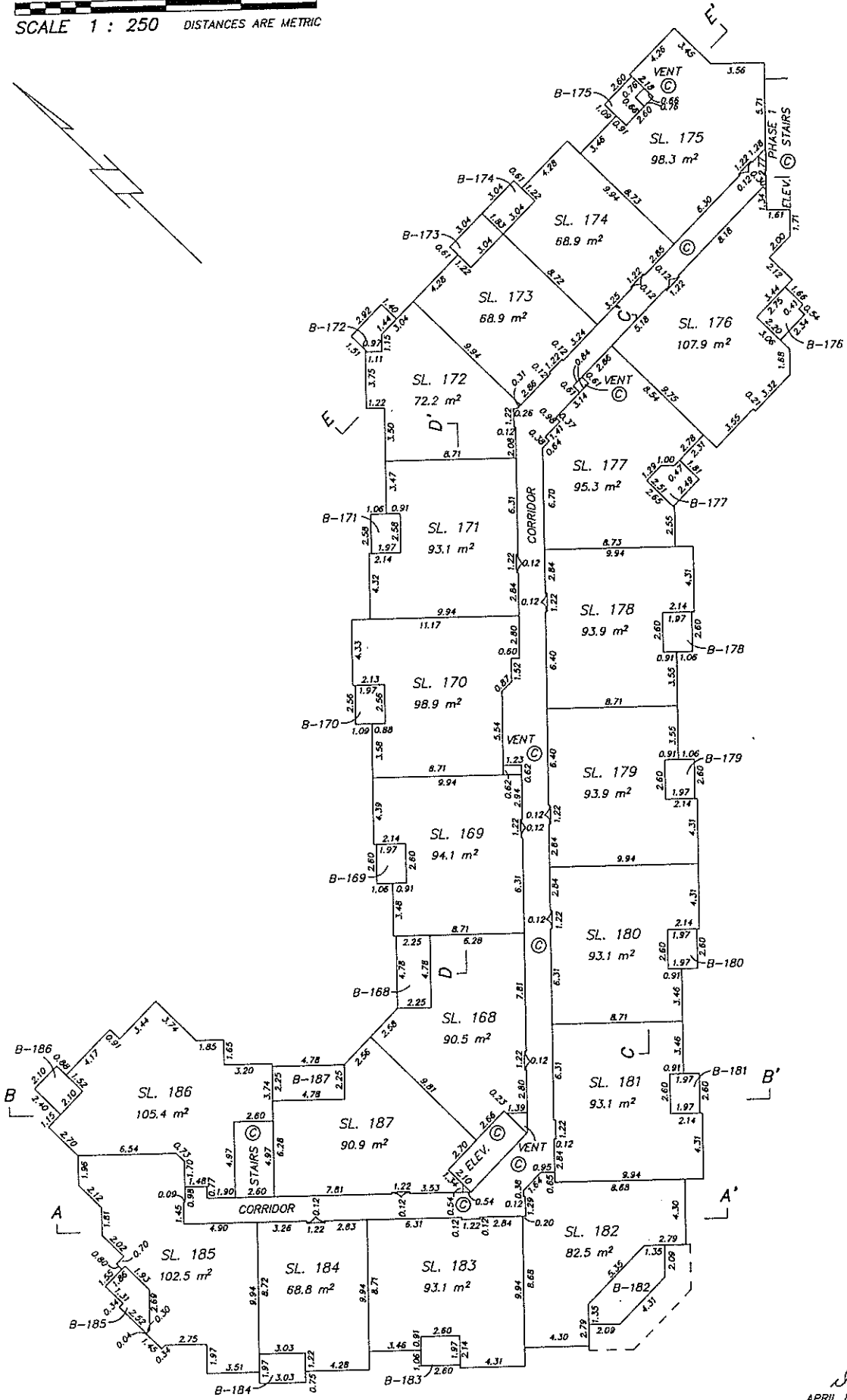
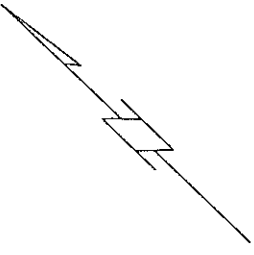
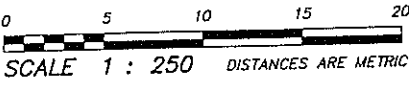

J.S.
APRIL 8, 1994
FILE: 92-1720

;

.

(

(

(

SECTIONS
 SCALE 1 : 250
 DISTANCES ARE METRIC

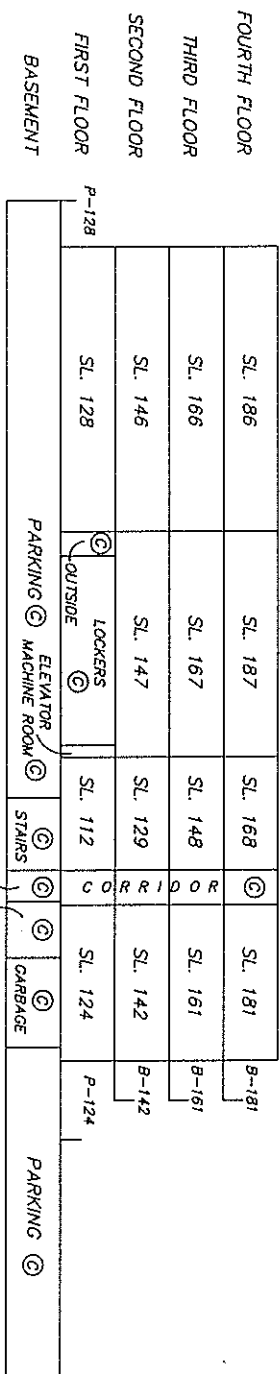
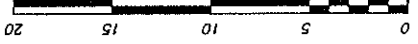

SECTION B - B'

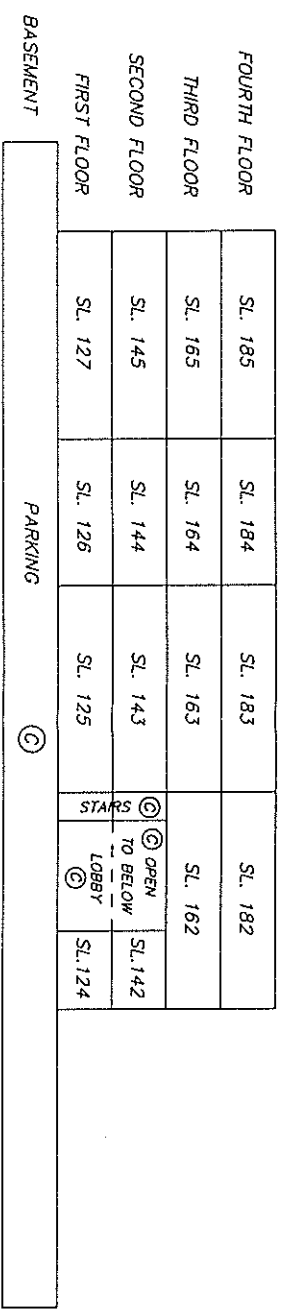

SECTION A - A'

.

(

(

(

SECTIONS

STRATA PLAN LMS908

PHASE TWO

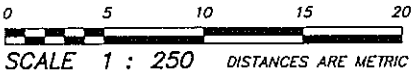

FOURTH FLOOR		SL. 172	SL. 173	SL. 174	SL. 175
THIRD FLOOR		SL. 152	SL. 153	SL. 154	SL. 155
SECOND FLOOR		SL. 133	SL. 134	SL. 135	SL. 136
FIRST FLOOR	P-116	SL. 116	SL. 117	SL. 118	LOCKERS Ⓢ
BASEMENT	STAIRS Ⓢ	PARKING			Ⓢ

SECTION E - E'

FOURTH FLOOR	SL.168	SL. 169	SL. 170	SL. 171	SL. 172
THIRD FLOOR	SL.148	SL. 149	SL. 150	SL. 151	SL. 152
SECOND FLOOR	SL.129	SL. 130	SL. 131	SL. 132	SL. 133
FIRST FLOOR	SL.112	SL. 113	SL. 114	SL. 115	SL. 116
BASEMENT		PARKING			Ⓢ

SECTION D - D'

FOURTH FLOOR	SL.181	SL. 180	SL. 179	SL. 178	SL. 177	SL.176
THIRD FLOOR	SL.161	SL. 160	SL. 159	SL. 158	SL. 157	SL.156
SECOND FLOOR	SL.142	SL. 141	SL. 140	SL. 139	SL. 138	SL.137
FIRST FLOOR	SL.124	SL. 123	SL. 122	SL. 121	SL. 120	SL.119
BASEMENT		PARKING			Ⓢ	

SECTION C - C'

(

(

(